

SANDWICH WALL AND CEILING PANEL OF TYPE LM

Systems from the LETHE “LM” family are available for walls or ceilings in various combinations of thicknesses and dimensions, surface and core materials and – last but not least – designs. This large variety of interaction with the balanced range of system profiles ensures that an optimized solution is available to meet almost any demand on board.

PANEL CODE

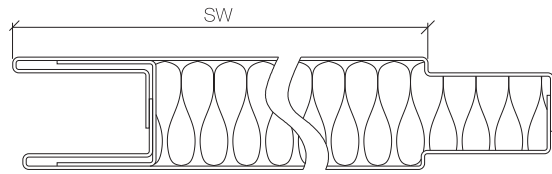

standard panel section

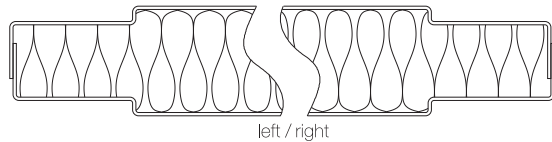

tongue direction

R ▷ hand side L ▽					
	B	A _{li}	D _{li}	P _{li}	n.a.
	A _{re}	C	I _{re}	T _{re}	S _{re}
	D _{re}	I _{li}	K	n.a.	N _{re}
	P _{re}	T _{li}	n.a.	R	n.a.
	n.a.	S _{li}	N _{li}	n.a.	n.a.

SYSTEM PROFILES (WALL)

end & T-joints	END/RW (LM 25/LM 50) for bare wall only	UP 1 (LM 25/LM 50)	UP 2 (LM 25/LM 50)	END/WA (LM 25/LM 50)
connection & corner	CP (LM 25/LM 50) for bare wall only	VB (LM 25/LM 50) for bare wall only	CPC (LM 25/LM 50)	ST 1 ST 2 (LM 25/LM 50)
sill	BP_D (LM 25/LM 50)	BP_C (LM 25/LM 50)	BP_B (LM 25/LM 50)	substructure

available in various material/pattern combinations

SYSTEM PROFILES (CEILING)

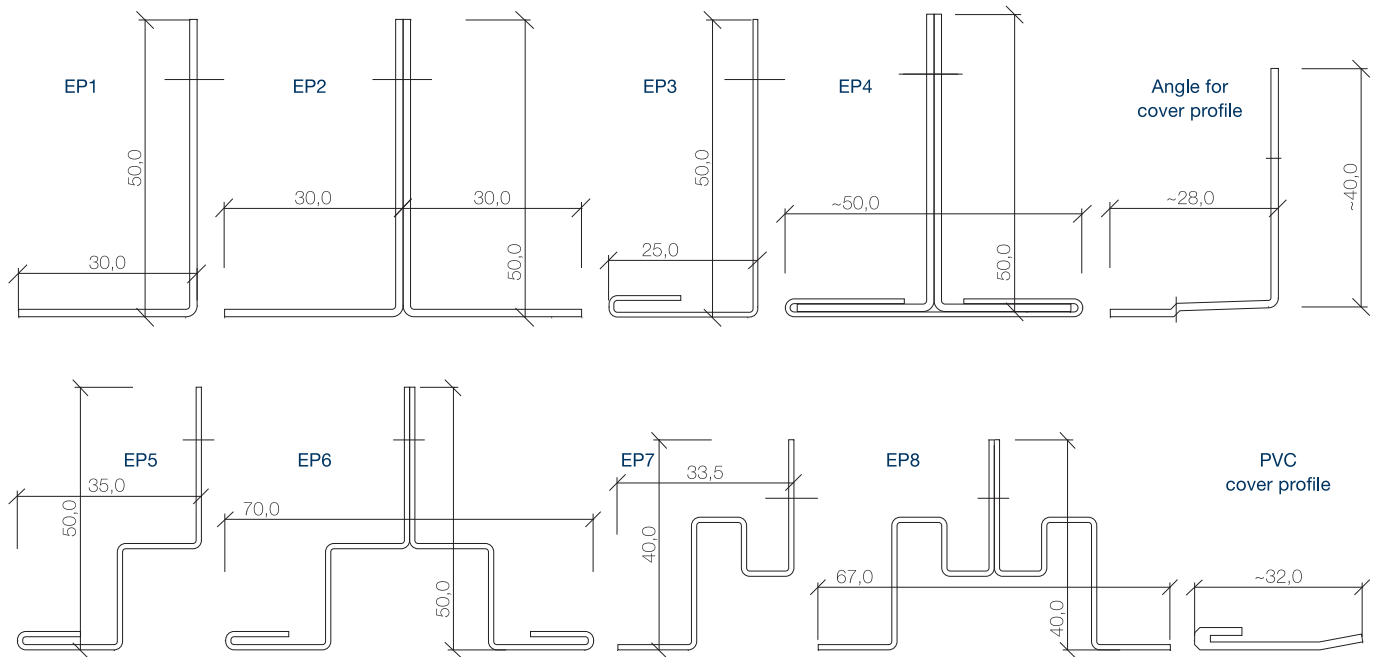

available in various material/pattern combinations

TECHNICAL DATA

System	Wall Ceiling	W1 C3		W3		W4 C2	W7	W7.1	
Thickness mm		25	50*	25	50	25	25	25	
Front mm		St 0,75		Al 0,80		St 0,75	St 0,75	Al 0,80	
Back mm		St 0,75		Al 0,80		Al 0,80	St 0,75	Al 0,80	
Core kg/m ³		MW 150		MW 150		MW 150	MW 150	MW 150	
Area weight kg/m ²		18,2	22,0*	10,0	13,5	14,0	18,2	10,0	
Fire classification		B15	B15*	B15	B15	B15	B0	B0	
Std. width (SW) mm		535							
Max. length mm		2.470					3.190		
Surface		raw/PVC foil/powder-coated/(stainless steel)							
Noise reduction dB(A)		26*	-	24	-	25*	-	-	
Certificate no.	Wall Ceiling	For latest certification numbers please contact us: info@lethe-hamburg.de							
Accessories		Revision hatches/Window boxes*/System profiles							

*wall systems only